

EQUAL TEE

STEEL FITTINGS

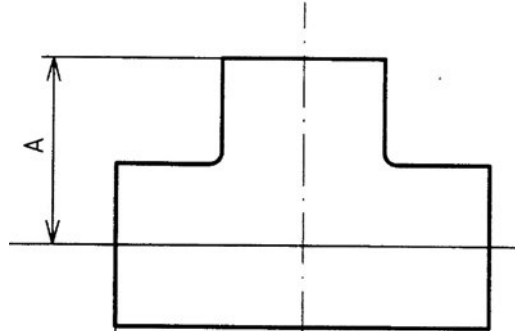

VALVES

GALVANISED
MALLEABLE

STAINLESS
STEEL FITTINGS

BLACK & GAL-
STEEL FITTINGS

HIGH PRESSURE
FITTINGS

CAMLOCKS

ROLL GROOVE

BUTTWELD

FLANGES

GVF CODE		DN SIZE (mm)	A (mm)	WEIGHT (kg)
BLACK STEEL	GAL STEEL			
BST006	GST006	6	16	0.06
BST008	GST008	8	22	0.17
BST010	GST010	10	24	0.14
BST015	GST015	15	32	0.19
BST020	GST020	20	35	0.26
BST025	GST025	25	43	0.41
BST032	GST032	32	51	0.66
BST040	GST040	40	52	0.09
BST050	GST050	50	64	1.27
BST065	GST065	65	76	2.03
BST080	GST080	80	89	3.15
BST100	GST100	100	115	5.50

MATERIALS	
Carbon Steel	0.25% Max C
Galvanising	HDG
Zinc Plating	EZP

SPECIFICATIONS
Thread
BSP to ISO 7-1
Cold Working Pressure
5000 kPa

STANDARD
Manufacturing
EN10241-2000