

STD WT LONG RADIUS ELBOWS 180° BUTTWELD

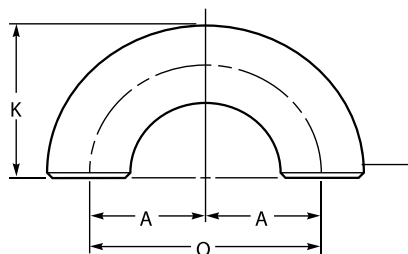

| GVF CODE 180° | DN SIZE (mm) | OD SIZE (mm) | WALL (mm) | A (mm) | O (mm) | K (mm) | WEIGHT (kg) |
|------------------|-----------------|-----------------|--------------|-----------|-----------|-----------|----------------|
| ESL180025 | 25 | 33.4 | 3.38 | 38 | 76 | 56 | 0.3 |
| ESL180032 | 32 | 42.2 | 3.56 | 48 | 95 | 70 | 0.51 |
| ESL180040 | 40 | 48.3 | 3.68 | 57 | 114 | 83 | 0.73 |
| ESL180050 | 50 | 60.3 | 3.91 | 76 | 152 | 106 | 1.3 |
| ESL180065 | 65 | 73 | 5.16 | 95 | 190 | 132 | 2.58 |
| ESL180080 | 80 | 88.9 | 5.49 | 114 | 229 | 159 | 4.04 |
| ESL180100 | 100 | 114.3 | 6.02 | 152 | 305 | 210 | 7.68 |

STD WT SHORT RADIUS ELBOWS 90° BUTTWELD

| GVF CODE 90° | DN SIZE (mm) | OD SIZE (mm) | WALL (mm) | A (mm) | WEIGHT (kg) |
|-----------------|-----------------|-----------------|--------------|-----------|----------------|
| ESS90025 | 25 | 33.4 | 3.38 | 25 | 0.1 |
| ESS90032 | 32 | 42.2 | 3.56 | 32 | 0.17 |
| ESS90040 | 40 | 48.3 | 3.68 | 38 | 0.24 |
| ESS90050 | 50 | 60.3 | 3.91 | 51 | 0.44 |
| ESS90065 | 65 | 73 | 5.16 | 64 | 0.86 |
| ESS90080 | 80 | 88.9 | 5.49 | 76 | 1.35 |
| ESS90100 | 100 | 114.3 | 6.02 | 102 | 2.56 |
| ESS90125 | 125 | 141.3 | 6.55 | 127 | 4.34 |
| ESS90150 | 150 | 168.3 | 7.11 | 152 | 6.76 |
| ESS90200 | 200 | 219.1 | 8.18 | 203 | 13.6 |
| ESS90250 | 250 | 273 | 9.27 | 254 | 24 |
| ESS90300 | 300 | 323.8 | 9.53 | 305 | 35.3 |
| ESS90350 | 350 | 355.6 | 9.53 | 356 | 45.4 |
| ESS90400 | 400 | 406.4 | 9.53 | 406 | 59.4 |
| ESS90450 | 450 | 457 | 9.53 | 457 | 75.4 |
| ESS90500 | 500 | 508 | 9.53 | 508 | 96 |
| ESS90600 | 600 | 559 | 9.53 | 610 | 140 |

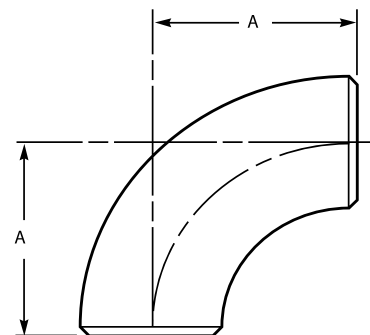

MATERIALS

ASTM A234 WPB
Carbon Steel Seamless

SPECIFICATIONS

Pressure Rating
As per ASME B31.3 (refer pg196)

STANDARD

Dimensional
ASME B16.9

VALVES

GALVANISED
MALLEABLESTAINLESS
STEEL FITTINGSBLACK & GAL
STEEL FITTINGSHIGH PRESSURE
FITTINGS

CAMLOCKS

ROLL GROOVE

BUTTWELD

FLANGES