

EQUAL CROSS

GALVANISED MALLEABLE FITTINGS

VALVES

GALVANISED
MALLEABLE

STAINLESS
STEEL FITTINGS

BLACK & GAL
STEEL FITTINGS

HIGH PRESSURE
FITTINGS

CAMLOCKS

ROLL GROOVE

BUTT WELD

FLANGES

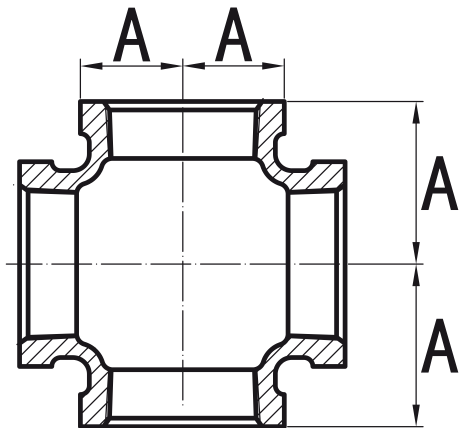

GVF CODE	DN SIZE (mm)	A (mm)	WEIGHT (kg)
GMCRS015	15	28	0.16
GMCRS020	20	33	0.24
GMCRS025	25	38	0.37
GMCRS032	32	45	0.58
GMCRS040	40	50	0.7
GMCRS050	50	58	1.12
GMCRS065	65	69	1.72
GMCRS080	80	78	2.4
GMCRS100	100	96	4.27

MATERIALS

Galvanised Malleable
Ductile Iron BS EN 1562

SPECIFICATIONS

Thread
BSP to ISO 7-1
Cold Working Pressure
1000 kPa

STANDARD

Dimensional
BS EN 10242