

ELBOW 45°, 90° & EQUAL TEE

HIGH PRESSURE - CLASS 3000LB

VALVES
 GALVANISED MALLEABLE
 STAINLESS STEEL FITTINGS
 BLACK & GAL STEEL FITTINGS
 HIGH PRESSURE FITTINGS
 CAMLOCKS
 ROLL GROOVE
 BUTTWELD
 FLANGES

GVF CODE ELBOW 90°	DN SIZE (mm)	B (mm)	L2 (mm)	A (mm)	G (mm)	H (mm)	WEIGHT (kg)
HPEFF008	8	8.1	10.2	25	3.3	25	0.15
HPEFF010	10	9.1	10.4	28	3.51	33	0.29
HPEFF015	15	10.9	13.6	33	4.09	38	0.42
HPEFF020	20	12.7	13.9	38	4.32	46	0.64
HPEFF025	25	14.7	17.3	44	4.98	56	1.14
HPEFF032	32	17	18	51	5.28	62	1.42
HPEFF040	40	17.8	18.4	60	5.56	75	2.63
HPEFF050	50	19	19.2	64	7.14	84	2.92
HPEFF065	65	23.6	28.9	83	7.65	102	5.99
HPEFF080	80	25.9	30.5	95	8.84	121	8.88
HPEFF0100	100	27.7	33	114	11.18	152	14.85

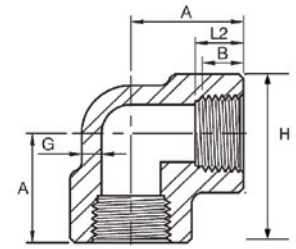

GVF CODE ELBOW 45°	DN SIZE (mm)	B (mm)	L2 (mm)	C (mm)	G (mm)	H (mm)	WEIGHT (kg)
HPE45008	8	8.1	10.2	19	3.3	25	0.12
HPE45010	10	9.1	10.4	22	3.51	33	0.24
HPE45015	15	10.9	13.6	25	4.09	38	0.37
HPE45020	20	12.7	13.9	28	4.32	46	0.56
HPE45025	25	14.7	17.3	33	4.98	56	0.94
HPE45032	32	17	18	35	5.28	62	1.03
HPE45040	40	17.8	18.4	43	5.56	75	2.05
HPE45050	50	19	19.2	44	7.14	84	2.23
HPE45065	65	23.6	28.9	52	7.65	102	4.19
HPE45080	80	25.9	30.5	64	8.84	121	6.15
HPE450100	100	27.7	33	79	11.18	152	11.67

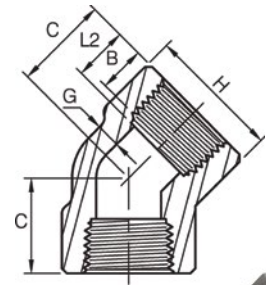

GVF CODE EQUAL TEE	DN SIZE (mm)	B (mm)	L2 (mm)	A (mm)	G (mm)	H (mm)	WEIGHT (kg)
HPT008	8	8.1	10.2	25	3.3	25	0.22
HPT010	10	9.1	10.4	28	3.51	33	0.38
HPT015	15	10.9	13.6	33	4.09	38	0.56
HPT020	20	12.7	13.9	38	4.32	46	0.92
HPT025	25	14.7	17.3	44	4.98	56	1.49
HPT032	32	17	18	51	5.28	62	1.76
HPT040	40	17.8	18.4	60	5.56	75	3.27
HPT050	50	19	19.2	64	7.14	84	3.53
HPT065	65	23.6	28.9	83	7.65	102	6.99
HPT080	80	25.9	30.5	95	8.84	121	10.19
HPT0100	100	27.7	33	114	11.18	152	19.13

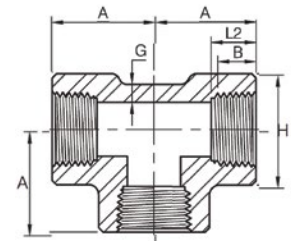

MATERIALS
Forged Carbon Steel
Also available in Hot Dipped Gal

SPECIFICATIONS
Thread
BSPT & NPT

STANDARD
Material
ASTM A105
Dimensional
ASME B16.11